

CS-HS1108pls S

10-port 10/100M PoE Switch

Sharp Series



OVERVIEW

The CS-H1108PLS is a 10/100M unmanaged PoE switch independently developed by CASE. It has 8 × 10/100M RJ45 ports and 2 × 10/100M uplink RJ45 ports. Ports 1–8 support PoE+ power supply, with single-port PoE power up to 30W.

As a PoE power supply device, it can automatically detect and recognize powered equipment that meets the standard and supply power through the network cable. It can provide power to PoE terminal equipment such as wireless APs, IP cameras, VoIP phones, and video access control intercoms through a network cable, meeting the requirements of network environments that need high-density PoE power supply.

It is suitable for hotels, campuses, factory quarters, and small- and medium-sized enterprises to form a cost-effective network. As an unmanaged model, it is plug-and-play, requires no configuration, and is easy to use.



FEATURE

■ 10/100Mbps access, Dual RJ45 port uplink

- ◇ Support non-blocking wire-speed forwarding for smoother transmission.
- ◇ Support full-duplex based on IEEE802.3x and half-duplex based on Backpressure.
- ◇ Provides 10*10/100Base-TX RJ45 ports for flexible networking and meets the networking requirements of various scenarios.

■ Smart PoE power supply

- ◇ 10*10/100Base-TX RJ45 ports, meeting the needs of security monitoring, teleconferencing system, wireless coverage, and other scenarios.
- ◇ Priority system for PoE port, it will supply power to the high priority level port first when the power budget is insufficient and avoid overwork of the device.
- ◇ Comply with PoE+ power standard, automatically identify PoE devices for power without damaging non-PoE devices, and the single port max PoE output power is 30W.

■ Innovative function

- ◇ EXTEND mode (250m): The speed of ports 1-8 is reduced to 10M when it is turned on, and the existing twisted-pair cable can be used to break through the limit of 100-meter transmission of twisted-pair cable, and the maximum transmission distance can reach 250 meters. On the other hand, It can solve the problem of poor transmission caused by line aging.
- ◇ VLAN mode: enabled together with the EXTEND mode, port 1-8 are isolated from each other but all communicate with port 9-10, which can prevent DHCP conflicts, optimize port cache utilization, and reduce broadcast storms.
- ◇ (Note: When the function switch is toggled to 250m mode, the port 1-8 extend transmission and port VLAN isolation function are enabled at the same time.)

■ Stable and reliable, easy to use

- ◇ CCC, CE, FCC, and RoHS.
- ◇ Plug and play, no need for configuration, easy to use and maintain.
- ◇ The user-friendly panel can show the device status through the LED indicator of PWR, and PoE.
- ◇ Low power consumption, no fan, galvanized steel shell, excellent heat dissipation to ensure stable operation of the equipment.

TECHNICAL SPECIFICATION

Model	CS-H1064PLS	CS-H1108PLS
Interface Characteristics		
Fixed Port	4*10/100Base-TX PoE ports (Data/Power) 2*10/100Base-TX uplink RJ45 ports (Data)	8*10/100Base-TX PoE ports (Data/Power) 2*10/100Base-TX uplink RJ45 ports (Data)
Ethernet Port	Port 1-6/ 1-10 can support 10/100Base-TX auto-sensing, full/ half duplex MDI/ MDI-X self-adaption	
Functional Switch	100m: 100 meters transmission, 250m: 10M/250 meters transmission and VLAN mode. Note: when the switch state changes, it must be restarted before the PoE switch function can take effect	
Twisted Pair Transmission	10BASE-TX: Cat5 or later UTP (≤250 meters) 100BASE-TX: Cat5 or later UTP (≤100 meters)	
Chip Parameter		
Network Protocol	IEEE802.3 10BASE-T, IEEE802.3i 10Base-T, IEEE802.3u 100Base-TX IEEE802.3x	
Forwarding Mode	Store and Forward(Full Wire Speed)	
Switching Capacity	1.6Gbps (Non-blocking)	2Gbps (Non-blocking)
Forwarding Rate@64byte	0.98Mpps	1.488Mpps
MAC	1K	2K
Buffer Memory	768K	1.25M
Jumbo Frame	1536byte	
LED Indicator	Power: PWR (Green), Network: Link(Yellow) PoE: PoE (Green), Functional switch:100m/ 250m (Green)	
PoE & Power Supply		
PoE Port	Port 1-4	Port 1-8

Power Supply Pin	1/2(+) 3/6(-)	
Max Power Per Port	30W, PoE+	
Total PWR / Input Voltage	65W/ (AC100-240V)	100W/ (AC100-240V)
Power Consumption	Standby<3W, Full load<65W	Standby<5W, Full load<100W
Power Supply	Built-in power supply, AC100~240V 50-60Hz, 1.1A	Built-in power supply, AC100~240V 50-60Hz, 2.2A
Physical Parameter		
Operation TEMP/ Humidity	-20~+55°C, 5%~90% RH Non condensing	
Storage TEMP/ Humidity	-40~+75°C, 5%~95% RH Non condensing	
Dimension (L*W*H)	142*115*40mm	195*130*40mm
Net /Gross Weight	0.55kg / 0.8kg	0.75kg /1.0kg
Installation	Desktop, Wall-mounted	
Certification & Warranty		
Lightning Protection	Lightning protection: 4KV 8/20us, Protection level: IP30	
Certification	CCC, CE mark, commercial, CE/LVD EN62368-1, FCC Part 15 Class B, RoHS	
Warranty	6 year	

DIMENSION

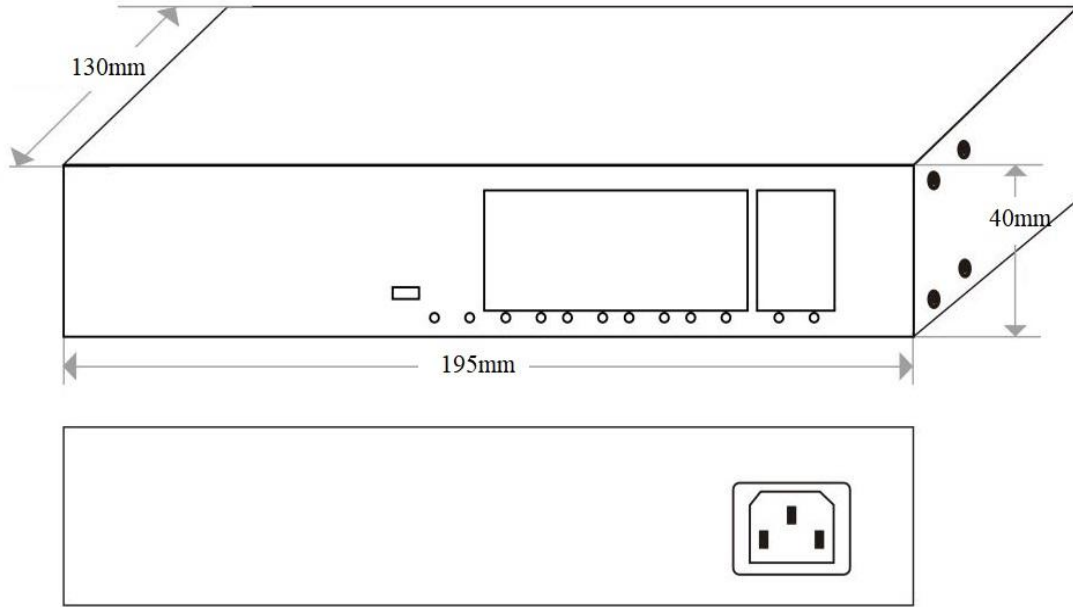

APPLICATION

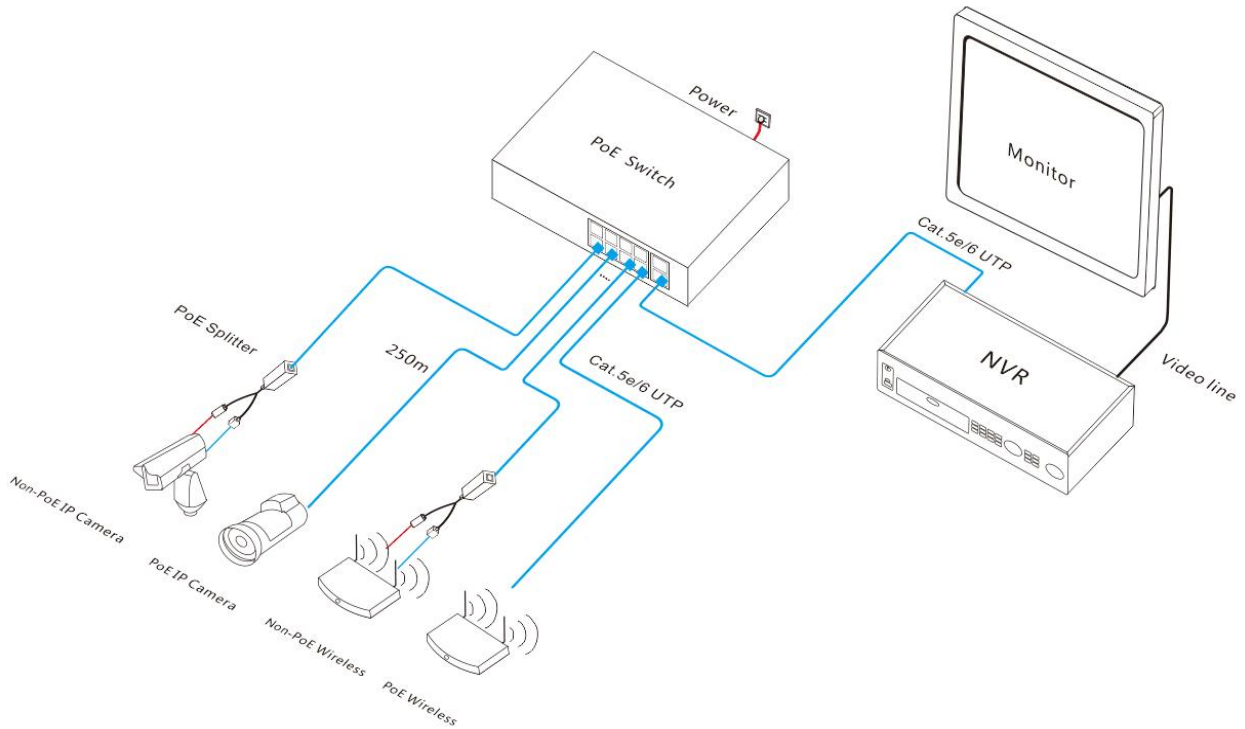

ORDERING INFORMATION

Model	Description	Built-in Power Supply
CS-H1064PLS	Unmanaged PoE switch with 4*10/100M RJ45 ports and 2*10/100M uplink RJ45 ports. Port 1-4 support PoE+ power supply. Adjust functional switch (250m), ports 1-4 support VLAN isolation and 10M/250 meters transmission.	65W/52V
CS-H1108PLS	Unmanaged PoE switch with 8*10/100M RJ45 ports and 2*10/100M uplink RJ45 ports. Port 1-8 support PoE+ power supply. Adjust functional switch (250m), ports 1-8 support VLAN isolation and 10M/250 meters transmission.	100W/52V

Note: Default not include mounting ears, need to purchased them!

PACKING LIST

	Content	Qty	Unit
Packing List	10-port 10/100M PoE switch	1	SET
	AC Power Cable	1	PC
	User Guide	1	PC
	Warranty Card	1	PC

